

**超高速
5000RPM**



FW-780-TB SERIES

横筒型超高速三针绷缝机
CYLINDER-BED SUPER HIGH SPEED INTERLOCK STITCH MACHINE



※ FW-780-TB SERIES MODELS



FW-780-TB-356/EWT/FL

横筒型高速三针绷缝机附左修刀功能
CYLINDER-BED SUPER HIGH SPEED INTERLOCK STITCH MACHINE (LEFT KNIFE)

全新设计之 FL (左切刀) 切布边功能, 容易操作、稳定性更佳。
适用各式针织品, T恤, 汗衫之下摆工作 (附左修刀修齐布边后, 再进行下摆车缝工作)

All new designed of left hand side fabric trimmer cut the extra fabric in easily and stable.
Applicable to all kinds of knitwear, T-shirt & Underwear for hemming stitch. (The left hand side fabric trimmer cut the extra fabric of edge to make it even for hemming.)

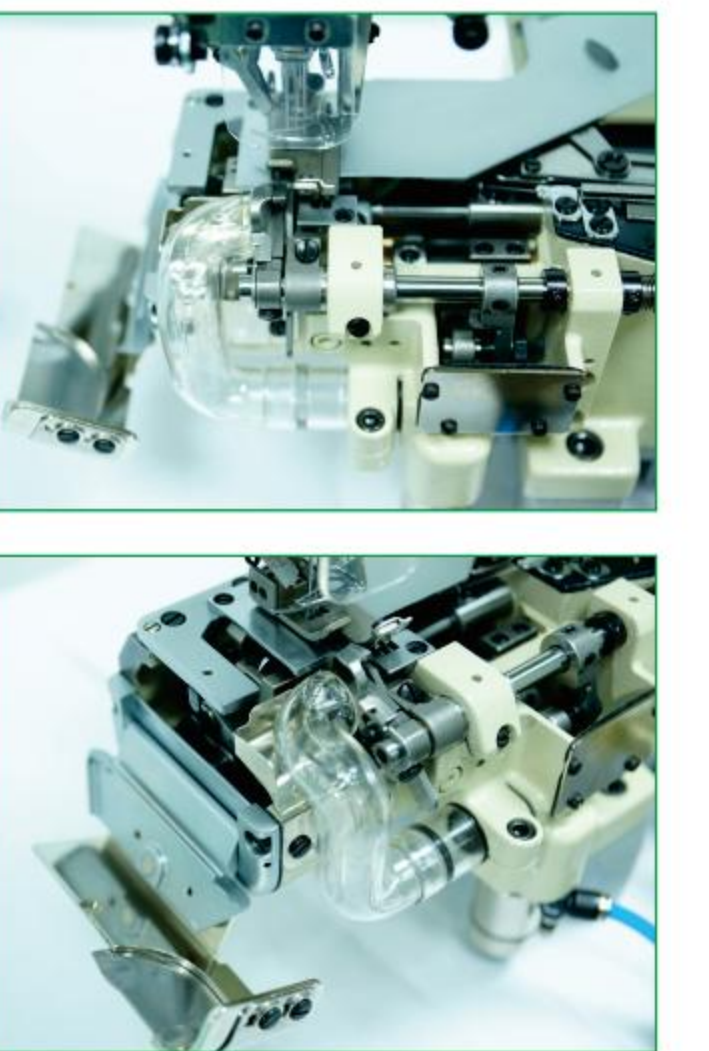

FW-780-TB-356/EWT/L1(L2)/FR

横筒型高速三针绷缝机附右修刀功能
CYLINDER-BED SUPER HIGH SPEED INTERLOCK STITCH MACHINE (RIGHT KNIFE)

全新设计之 FR (右切刀) 切布边功能, 容易操作、稳定性更佳。
适用于男女内裤裤腰之松紧带缝合, 配合右切刀装置, 更能提高缝制品质。

The brand-new design "Right Hand Side Fabric Trimmer" operates in easy and stable.
Applicable to men & women underpants for attach the elastic waist-band.
The "Right Hand Side Fabric Trimmer" increases sewing quality.

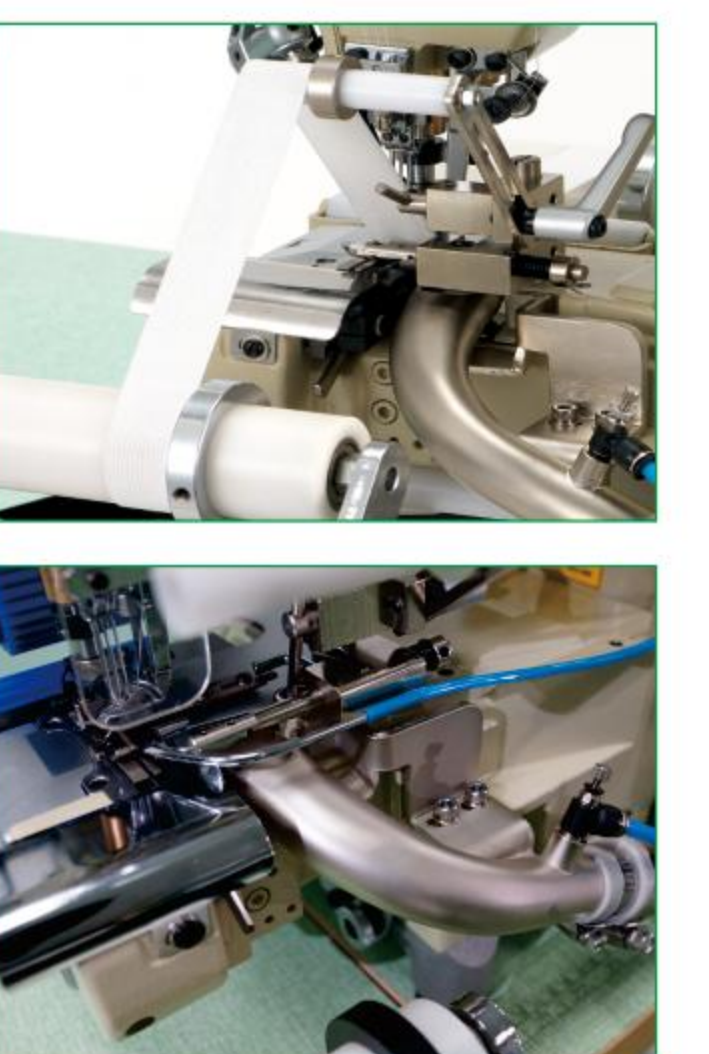

FW-780-TB-356/T

横筒型高速三针绷缝机附上送机构
CYLINDER-BED SUPER HIGH SPEED INTERLOCK STITCH MACHINE (TOP FEED)

因为上输送、下输送的驱动各自独立, 所以能保持较大的差动比, 使输送效率进一步提高, 因此可以解决在重缝段部的缝堵和跳线, 也能实现美观的下摆折缝工序。

Because the upper transmission device and lower transmission device are separately, so it can keep big differential ratio then the transmission efficiency will be further raised.

**【采用专利设计的无段变速机构
零件不易磨损, 拉力强, 更耐用】**

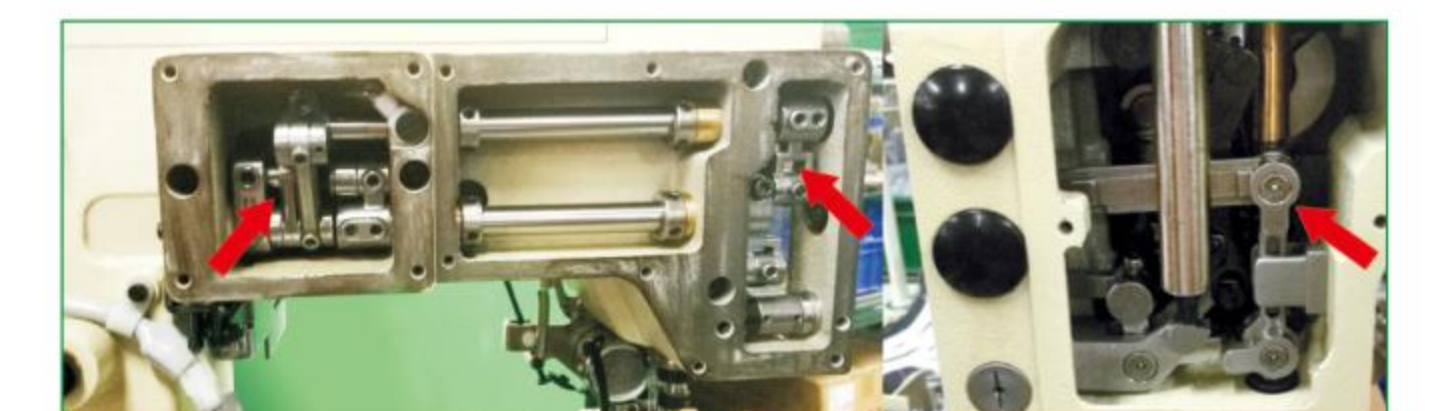

※ SPECIFICATION

型号	针数	针距	送料	压脚	速度	其他
FW-780-TB-240	2	3			4.0	
FW-780-TB-248	2	3			4.8	
FW-780-TB-348	3	5			4.8	
FW-780-TB-356	3	5	1.4-4.5		5.6	7.0
FW-780-TB-364	3	5			6.4	
FW-780-TB-456	4	6			5.6	
FW-780-TB-460	4	6			6.0	
FW-780-TB-464	4	6			6.4	

※ DEVICE NO

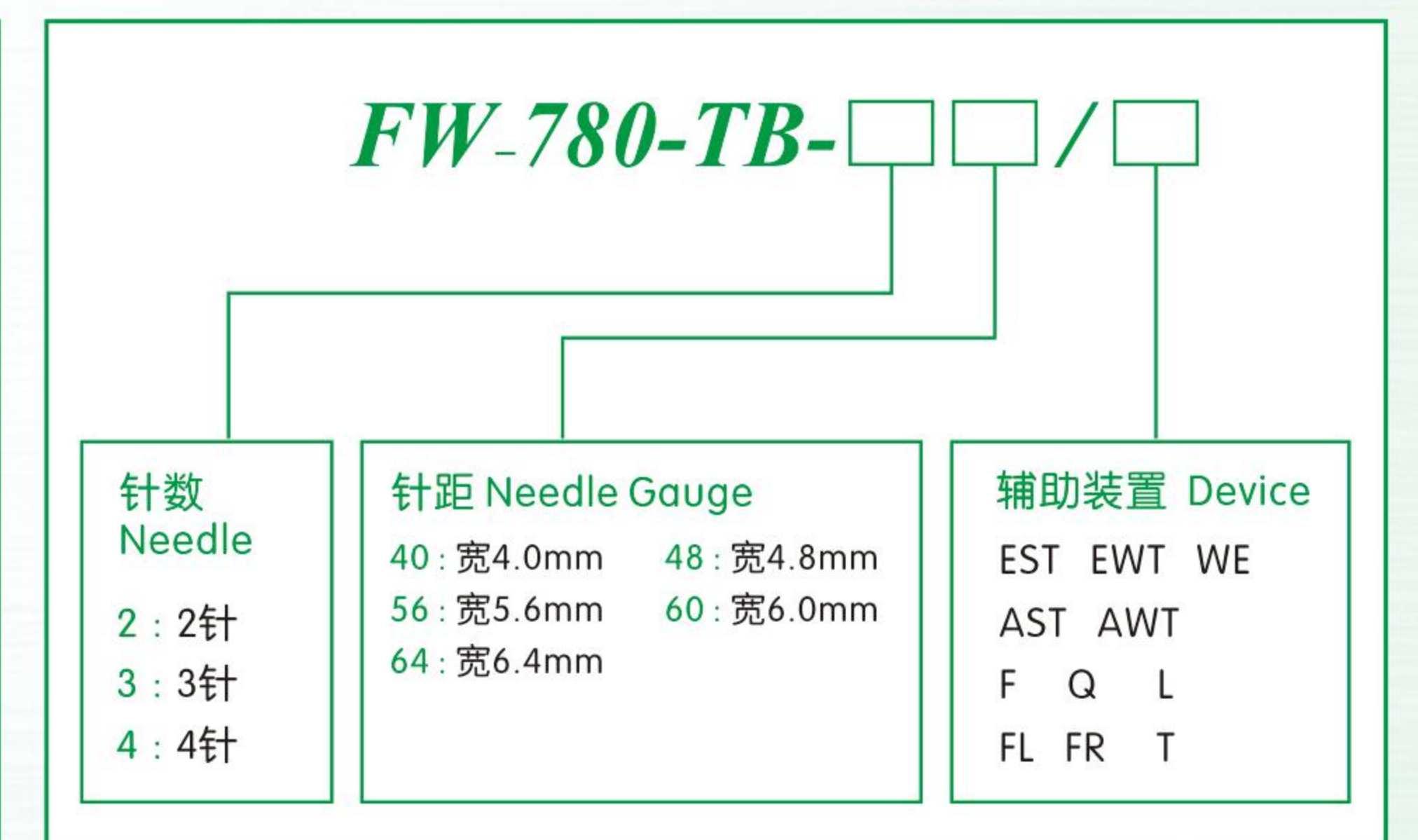

※ 经销商 AGENT



星锐缝纫机股份有限公司
SHING RAY SEWING MACHINE CO., LTD.
星锐缝纫机(嘉兴)有限公司
SHING RAY SEWING MACHINE (JIAXING) CO., LTD.

本目录所记载的规格式样或外观, 因加以改良, 有时不预告即加以变更, 请见谅。
This specifications is this catalog are subject to change without notifications.



FW-780-TB



微型电控与机头完美结合,除了美观、操作方便,更使得操作空间加大。



创新机电一体技术

The micro-electric control is perfectly combined with the machine head on the table. In addition to the beautiful appearance and convenient operation, the operation space is increased.

采用特殊的中空零件,内部强制给油,稳定耐用;为机器高速运转保驾护航。



内部零部件强制给油

Adopts special hollow parts for forced lubricant supply. It ensures machine super high speed running stably and durably.

进油 OIL IN 出油 OIL OUT

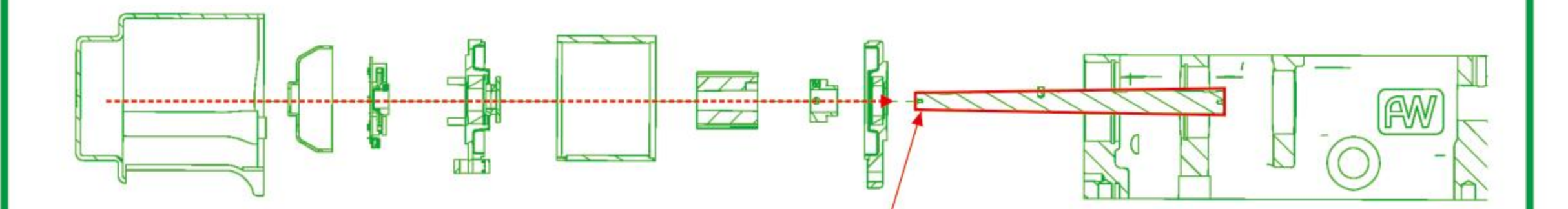

主轴与马达同轴驱动 (锥形主轴更稳定)

专利设计的无心马达

采用专利设计的无心马达,主轴与马达同轴驱动平衡系数更高,性能更稳定; Patented Centerless Motor enable machine head and motor use the Same Spindle. The drive balance coefficient is higher and machine performance is even more stable.

采用新型陶瓷过线结构,穿线简单,过线顺滑,有效的延长机器使用寿命。

新型陶瓷过线结构

With the special Ceramic Threading structure, threading is simple and the thread goes smoothly. It effectively increases machine durability.

专利设计的上饰线切线刀,可依使用者之需求调整至最佳切线角度。

(台湾专利号第135363号)

多向可调式上饰线切线组

The patent design top thread trimmer could follow user requested to adjust any precise cutting angle.

(optional: Anti-skip-thread knife)

专利设计的底线切刀结构,切线更稳定,调校更方便;

(中国专利号: ZL 01 2 54752.2)

可选配专利设计的底线切线刀片,有效防止脱线。

(台字号第 1565848号)

微调式底线切线组

Patented Bottom Thread Cutter is easy to be adjusted perfectly. It cuts thread very stable. Brand new designed optional bottom thread knife effectively prevents skip-thread.

(optional: Anti-skip-thread knife)

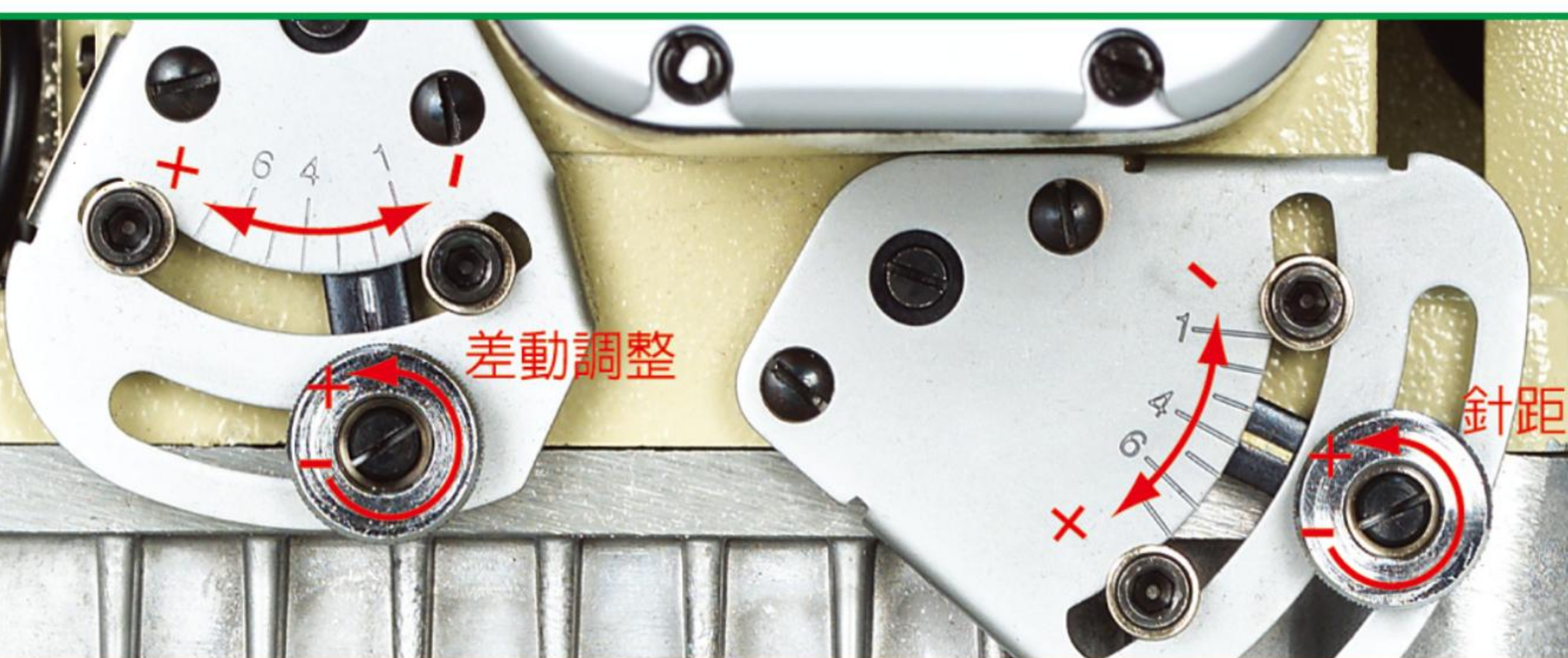
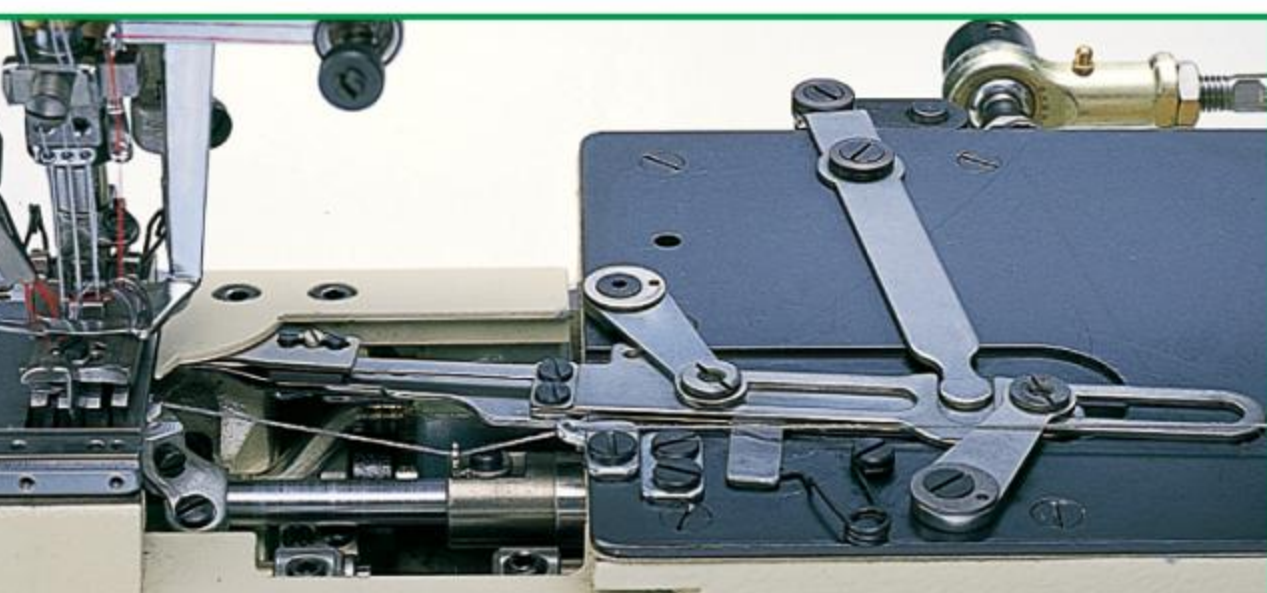
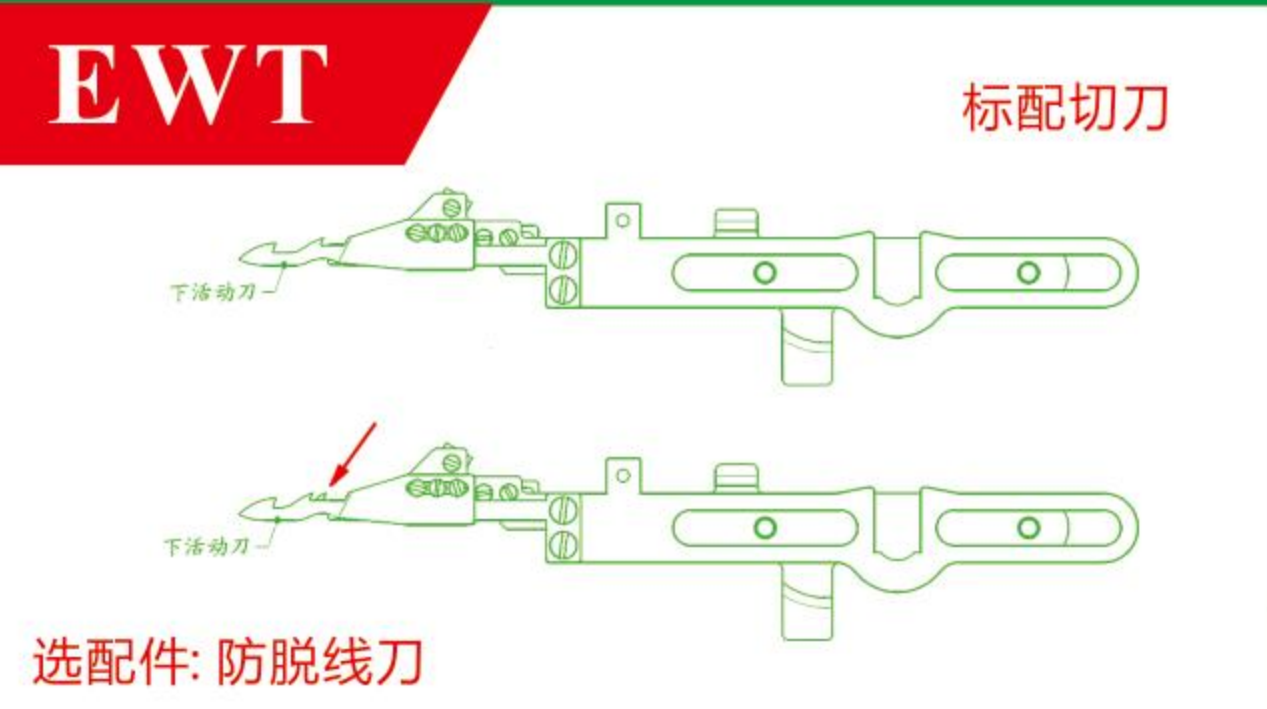

独立差动调整机构

采用专利设计的摇杆式独立差动调整机构,提供充分的差动进给量,轻松应对各种面料。

Patented rocker-type independent differential feed adjustment mechanism provides sufficient differential feed ratio to handle a big variety of fabrics easily.



拨线加自动剪线(可选配)

拨线、自动剪线可同时加装,不漏针,不脱线,线头更适宜,转弯更顺畅。

Both Thread Wiper and Cutter can be installed on one machine at the same time, no skip stitches, nice thread end and smooth stitches turning.



单向式后拖轮组

加长下滚轮长度,使送布稳定,降低故障率,更换容易,不因速度快慢,产生大小针。(L1表示齿轮,L2表示平轮)

To extend the length of lower Feed Roller. To offer you more stable feeding, Low Break-down and easy to repair. The machine speed don't disturb the stitch length.



喇叭包边装置(可选配)

加装辅助件Q组,即可实现折下摆、埋压拷克骨、包边三种基本功能合一的多功能、切换容易之省钱机种。

Hemming, Covering, Piping, Three basic Functions in one, Flexing, Cost Saving machine. (QHC 三合一功能)



上裤腰装置

"卡钳式"膝动开关,无须切割桌板、钻孔、装钉螺丝,安装简单。

"折叠式"连杆设计,开启前盖方便。 "Clamp Type" knee switch which don't need to cut the table, drill a hole, installed by screw. It easy to set it up.